

Nanded Pharmacy College, Nanded

Criterion 4. Infrastructure and Learning Resources.

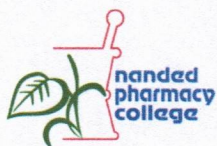

Nanded Pharmacy College, Nanded

4.1.1

The Institution has adequate infrastructure and physical facilities for teaching-learning. viz., classrooms, laboratories, computing equipment, etc.



Shri Sharda Bhavan Education Society's

NANDED PHARMACY COLLEGE

Shyam Nagar, Nanded - 431 605 Maharashtra India (19.175868,77.307992)

Phone – 91 2462 254347 Tele fax No. 91 2462 254445 (O)

Visit: www.nandedpharmacycollege.org.in ; Email: ssbesnpc146@gmail.com

Affiliated to Swami Ramanand Teerth Marathwada University, Nanded, www.srtmun.ac.in

Approved by PCI & AICTE, New Delhi; College DTE Code: 2149; College SRTM University Code: 146

Ref. No. NPC / B. Pharm/

Date:

INDEX

Sr. No	Document	Page Number
01	Details of Physical Infrastructure	
i	Administrative Area	1
ii	Instructional Area	2
iii	Student's Facility & Amenities Area	3
iv	Circulation Area.	4
v	Area statement.	5
vi	Permission to use Sports/gymnasium/ Yoga center facility.	8
vii	Lay out a plan for the Animal House.	9
viii	Animal House Registration.	10
ix	Photos	14



Shri Sharda Bhavan Education Society's

NANDED PHARMACY COLLEGE

Shyam Nagar, Nanded - 431 605 Maharashtra India
Phone – 91 2462 254347 Tele fax No. 91 2462 254445 (0)

Visit: www.nandedpharmacycollege.org.in ; Email: ssbesnpc146@gmail.com

Affiliated to Swami Ramanand Teerth Marathwada University, Nanded, www.srtmun.ac.in

Approved by All India Council for Technical Education, New Delhi, www.aicte-india.org

Ref. No. NPC / B. Pharm/2018-19/

Date:

Details of Physical Infrastructure

I] Administrative Area

Sr No	Name of Infrastructure	Required (Sq.mts)	Available (Sq.mts)
01	Principal's Chamber	30	30
02	Board/Meeting Room	20	20
03	Office: Establishment /Academic / Confidential room / Exam Control / Stationary Store	60x2	150
04	HOD Cabins	20x4	80
05	Faculty Room	10x n	Available adjoining HOD cabin
06	Security Room	--	10
07	Placement Office	--	30

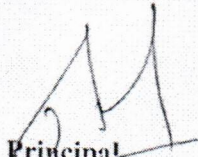
Principal
Prof.(Dr.) N. B. Ghiware
Principal
Nanded Pharmacy College
Nanded.

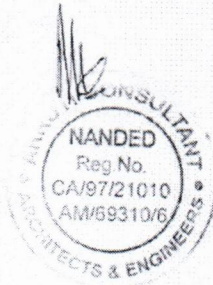

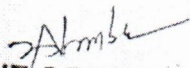
JOINT SECRETARY
SHRI SHARDA BHAVAN
EDUCATION SOCIETY, NANDED

Prof.(Dr.) N. B. Ghiware
PRINCIPAL
Nanded Pharmacy College,
Nanded.





Shri Sharda Bhavan Education Society's

NANDED PHARMACY COLLEGE

Shyam Nagar, Nanded - 431 605 Maharashtra India

Phone - 91 2462 254347 Tele fax No. 91 2462 254445 (O)

Visit: www.nandedpharmacycollege.org.in; Email: ssbesnpc146@gmail.com

Affiliated to Swami Ramanand Teerth Marathwada University, Nanded, www.srtmun.ac.in

Approved by All India Council for Technical Education, New Delhi, www.aicte-india.org

Ref. No. NPC / B. Pharm/2018-19/

Date:

Details of Physical Infrastructure

II] Instructional Area*

Sr No	Name of Infrastructure	Required (Sq.mts)	Available (Sq.mts)
01	Class Room 1,2, 3	Min 75 x3	75 x2, 130x1 Total : 280
02	Tutorial Room	33x1	33
03	Laboratory		
	Pharmaceutics	75-90	120#
	Pharmaceutics Lab + Machine Room	75-90	120#
	Pharmaceutical Chemistry	75-90	120#
	Pharmaceutical Analysis	75-90	100#
	HAP & Pharmacology	75-90	120#
	Pharmacognosy	75-90	100#
	Microbiology/Biotechnology	75-90	100#
	Pharmacology Lab (PG)	75-90	70
04	Central Instrument Room	80	80
05	Store Room (1+2 {for inflammable})	100+20	120
06	Animal House	80	100
07	Library including reading room	150	270
08	Computer Centre	75	80
09	Seminar Hall	--	150

*For 40 intake of B. Pharm & 15 Intake of M. Pharm Pharmacology; #including preparation room

Principal

Prof.(Dr.) N. B. Ghiware
Principal
Nanded Pharmacy College,
Nanded.

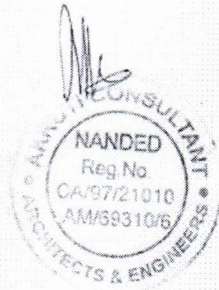

JOINT SECRETARY
SHRI SHARDA BHAVAN
EDUCATION SOCIETY, NANDED

Prof.(Dr.) N. B. Ghiware
PRINCIPAL
Nanded Pharmacy College,
Nanded.





Shri Sharda Bhavan Education Society's

NANDED PHARMACY COLLEGE

Shyam Nagar, Nanded - 431 605 Maharashtra India

Phone - 91 2462 254347 Tele fax No. 91 2462 254445 (O)

Visit: www.nandedpharmacycollege.org.in; Email: ssbesnpc146@gmail.com

Affiliated to Swami Ramanand Teerth Marathwada University, Nanded, www.srtmun.ac.in

Approved by All India Council for Technical Education, New Delhi, www.aicte-india.org

Ref. No. NPC / B. Pharm/2018-19/

Date:

Details of Physical Infrastructure

III] Student's Facility & Amenities Area

Sr No	Name of Infrastructure	Required (Sq.mts)	Available (Sq.mts)
01	Girls Common Room	60	75
02	Boy's Common Room	60	75
03	Toilet Blocks for Girls	24	24
04	Toilet Blocks for Gents	24	50
05	Canteen/Cafeteria	100	150
06	First Aid cum seek room	--	20
07	Auditorium/Amphitheatre	250-300 seating capacity	Open to Air Theatron is available app 290 sq.mts
08	Drinking Water facility	--	Available
09	Girls Hostel (Desirable)	9-20sq.mts/room	Common Girls Hostel of Management is bordering to College
10	Boy's Hostel (Desirable)	9sq.mts/room	Nil
11	Parking area for staff & students	--	Adequate
12	Principal Quarter (Desirable)	80	Nil
13	Staff Quarter (Desirable)	16x80	Nil
14	Bank Extension Counter (Desirable)	--	Nil
15	Cooperative Store (Desirable)	--	Nil
16	Guest House	80	Nil
17	Transport Facility for Students	--	Nil

Principal

Prof.(Dr.) N.B.Ghiware
Principal
Nanded Pharmacy College
Nanded.

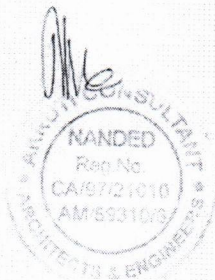

JOINT SECRETARY
SHRI SHARDA BHAVAN
EDUCATION SOCIETY, NANDED



Prof.(Dr.) N.B. Ghiware
PRINCIPAL
Nanded Pharmacy College,
Nanded.



Shri Sharda Bhavan Education Society's

NANDED PHARMACY COLLEGE

Shyam Nagar, Nanded - 431 605 Maharashtra India

Phone – 91 2462 254347 Tele fax No. 91 2462 254445 (O)

Visit: www.nandedpharmacycollege.org.in ; Email: ssbesnpc146@gmail.com

Affiliated to Swami Ramanand Teerth Marathwada University, Nanded, www.srtmun.ac.in

Approved by All India Council for Technical Education, New Delhi, www.aicte-india.org

Ref. No. NPC / B. Pharm/2018-19/

Date:

Details of Physical Infrastructure

IV] Circulation Area

Sr No	Name of Infrastructure	Required (Sq.mts)	Available (Sq.mts)
01	Corridors	--	300
02	Other Area	--	140
03	Other Common Area	--	42

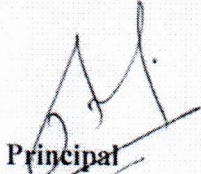

Principal

Prof.(Dr.) N. B. Ghiware
Principal
Nanded Pharmacy College
Nanded.

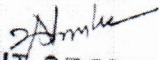

JOINT SECRETARY
SHRI SHARDA BHAVAN
EDUCATION SOCIETY, NANDED



Prof.(Dr.) N. B. Ghiware
PRINCIPAL
Nanded Pharmacy College,
Nanded.

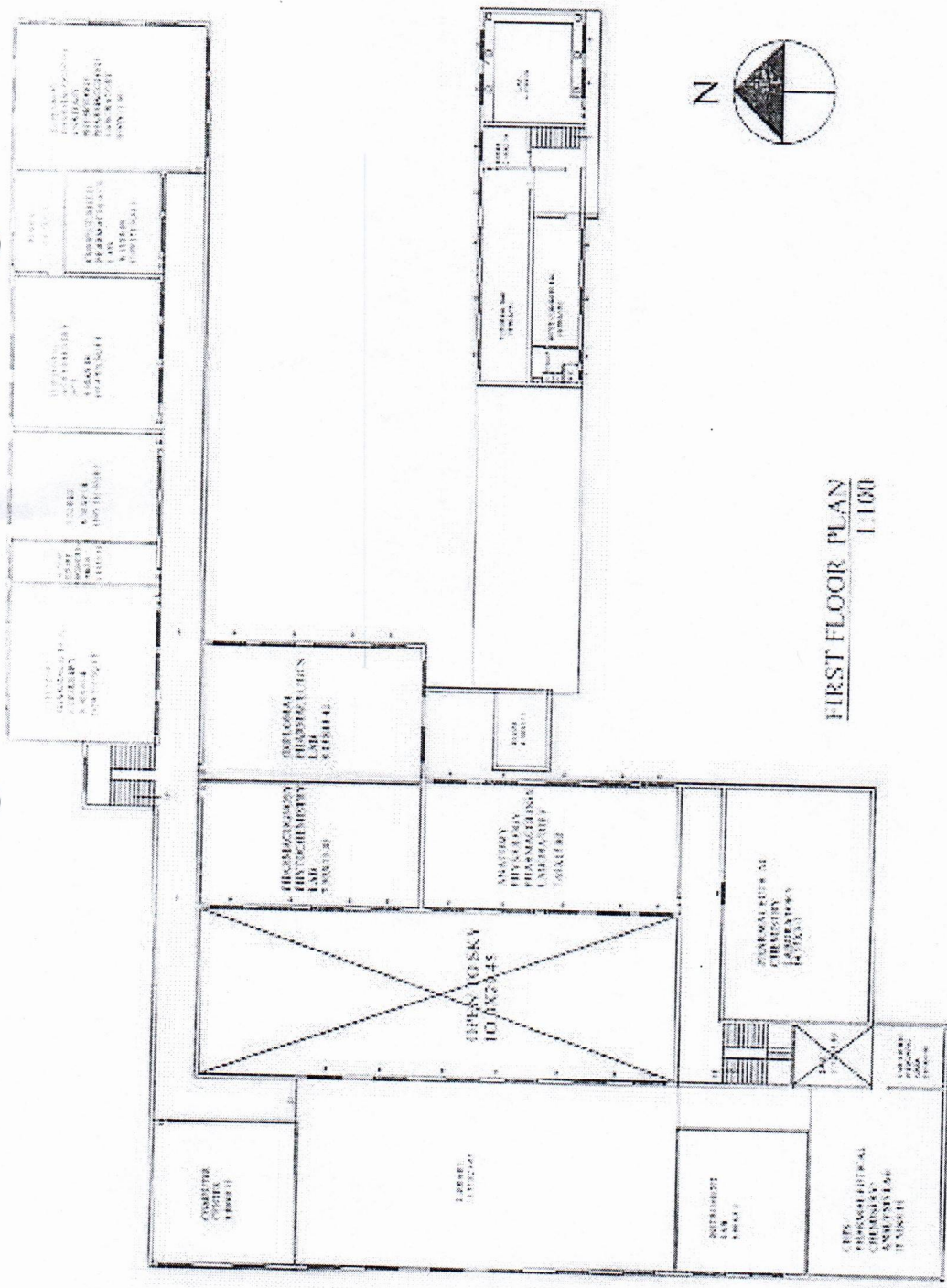

FIRST FLOOR PLAN
1:100

AREA STATEMENT

A) LAND AREA = 3 ACRE (100,000 SQ. M)

B) BUILT UP AREA

a) Ground Floor = 1466.80 SQ. M.

b) First Floor = 1340.90 SQ. M.

c) Second Floor = 237.50 SQ. M.

Total Area = 3044.99 SQ. M.

C) CARPET AREA = 2530.59 SQ. M.

SHRI. SHARDA BHAVAN EDUCATION SOCIETY'S
NANDED, PHARMACY COLLEGE, (DEGREE)

(Signature)

JOINT SECRETARY
SHRI SHARDA BHAVAN
EDUCATION SOCIETY NANDED

Prof. (Dr.) H. B. Ghisware
Principal
Nanded Pharmacy College
Nanded.

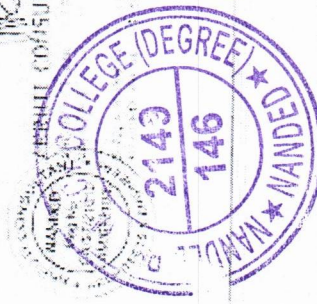

MANAGED BY
CONSULTANTS
NANDED

(Signature)
Prof. (Dr.) N. B. Ghisware
PRINCIPAL
Nanded Pharmacy College,
Nanded.

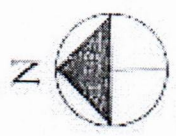
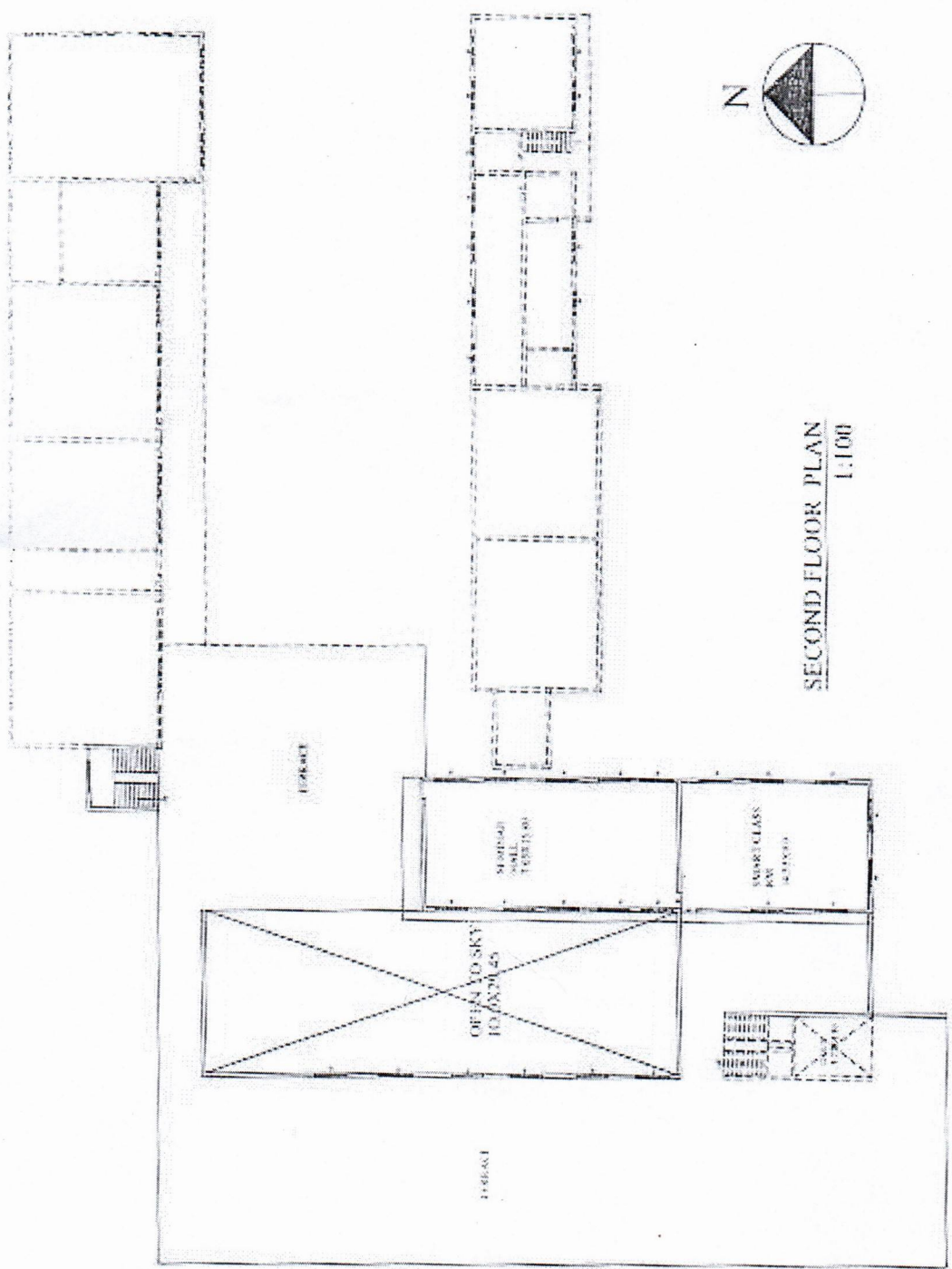

SECOND FLOOR PLAN
1:100

SHRI. SHARDA BHAVAN EDUCATION SOCIETY'S NANDED
PHARMACY COLLEGE, (DEGREE)

AREA STATEMENT	
A) LAND AREA = 2 ACRE (8100.0 SQ.M.)	
B) BUILT UP AREA	
a) Ground Floor = 1566.50 SQ. M.	
b) First Floor = 1300.00 SQ. M.	
c) Second Floor = 237.50 SQ. M.	
Total Area = 3044.00 SQ. M.	
C) CARPET AREA = 2530.50 SQ. M.	

Prof. Dr. N. B. Ghiware
Principal
Nanded Pharmacy College
Nanded.

JOINT SECRETARY
SHRI SHARDA BHAVAN
EDUCATION SOCIETY NANDED

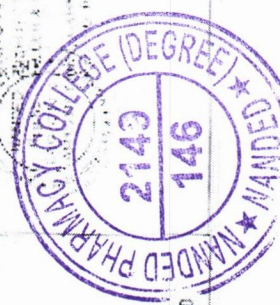

CONSULTANTS
M. S. KRISHNA
M. S. KRISHNA
M. S. KRISHNA
M. S. KRISHNA

Prof. (Dr.) N. B. Ghiware
PRINCIPAL
Nanded Pharmacy College,
Nanded.

Handwritten signature



Shri Sharada Bhavan Education Society's
YESHWANT MAHAVIDYALAYA, NANDED-431602 (M.S.)
(Affiliated to Swami Ramanand Teerth Marathwada University, Nanded)
NAAC Reaccredited "A" Grade (IIIrd Cycle)
'COLLEGE WITH POTENTIAL FOR EXCELLENCE STATUS'

UG-Arts, Science, Commerce, B.Sc.(C.S.), B.Sc.(B.T.), PG-Economics, History, English, Sociology, M.Com., Chemistry, Zoology, Environmental Science, Microbiology, Computer Science, Dairy Science, MCM, Information Technology, Biotechnology, Electronics, Botany, PG Diploma in Tax Procedure & Practice, PG Diploma in Electronics/Embedded System Design, **Research Center** in Biotechnology, Botany & Horticulture, Chemistry, Commerce, Computer Science & Information Technology, Dairy Science, Economics, Electronics, English, Environmental Science, Hindi, History, Marathi, Mathematics & Statistics, Microbiology, Political Science, Physics, Urdu & Zoology)

Establishment Year: 1963

Hon'ble Shri Ashokrao Chavan
President

Shri D.P.Savant
Secretary

Dr.Ganeshchandra Shinde
Principal

Phone No.s:- (02462) 254170, 254487(Office), 253726(Fax)

website: www.ymnanded.in Email: principalymn@gmail.com

Ref.No.:-YMN/2019-2020/ 849-A

Date:-7.8.2019.

To,
The Principal,
Nanded Pharmacy College,
Nanded.

Subj:- Permission to use Sports/Gymnasium/Yoga Centre facility to your
College Staff and Students.

Ref.:- Your letter No.NPC/B.Pharm/2019-20/155/01, dt.22.7.2019.

Sir,

With reference to the above cited subject, this college has permitted to use this college Sports facility (Indoor Facilities available in Sports Complex, Outdoor facilities, Gymnasium, Yoga Centre) to your college staffs and Students.

Students and Staff will carry their Identity Card at the time of using sports facility in this College campus. Follow the Sports guidelines, Rules and Regulations and further details to contact Dr.M.M.Painjane, Director of Physical Education of this college.

Thanking you,

Yours faithfully,

(Signature of Dr. Ganeshchandra Shinde)
(Dr.Ganeshchandra Shinde)
Principal
PRINCIPAL
Yeshwant Mahavidyalaya
NANDED.



Sanghis / Poyel
*Keep it as record if
inform to incharge of students*

1. The Secretary, Shri Sharada Bhavan Education Society, Nanded.

2. Dr.M.M.Painjane, Director of Physical Education, Yeshwant Mahavidyalaya, Nanded.

(Signature of Dr. M.M. Painjane)
DR. M.M. PAINJANE
Nanded Pharmacy College,
Nanded.

ANIMAL HOUSE FOR NANDED PHARMACEY COLLEGE
SHYAM NAGAR NANDED.

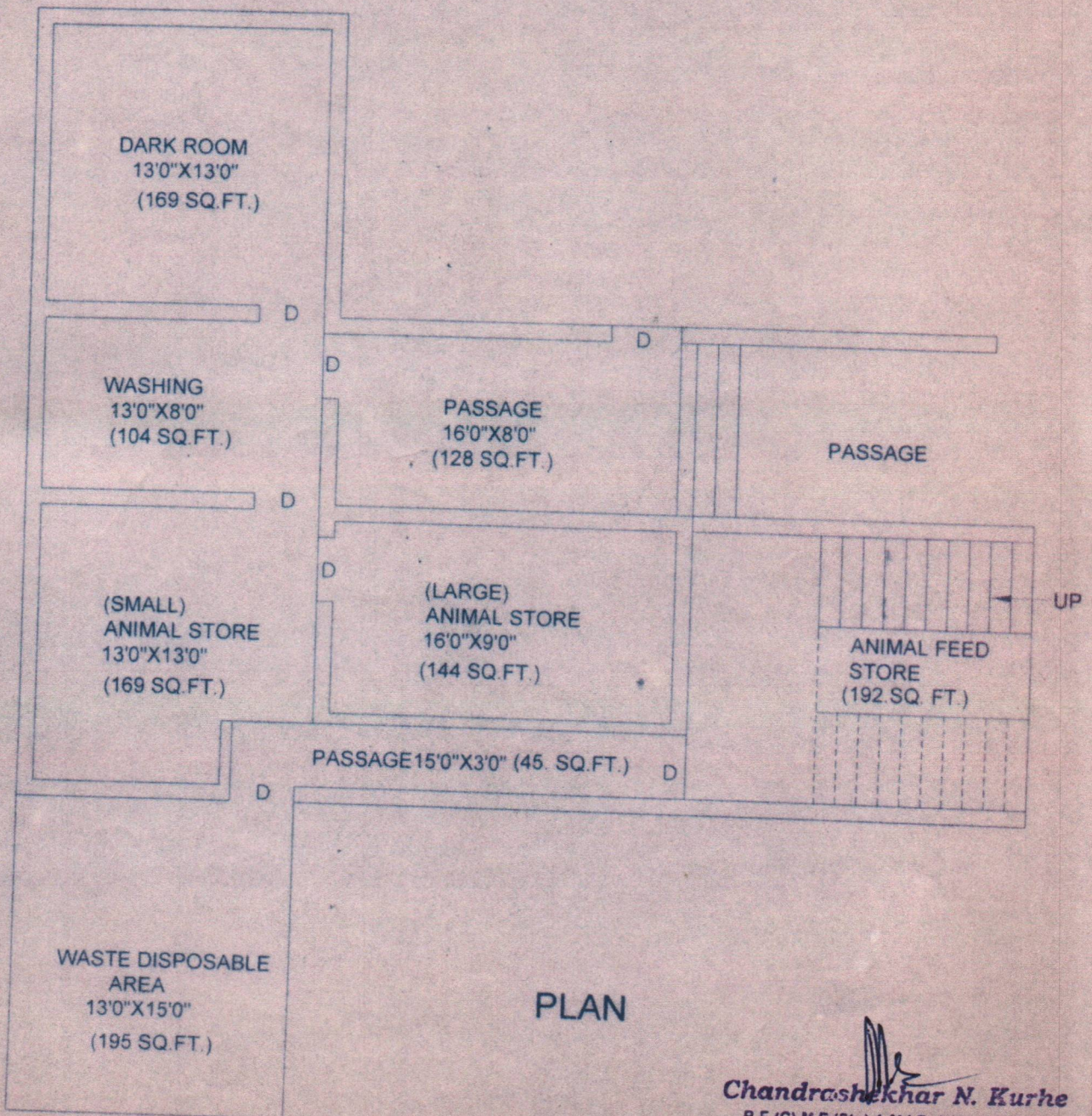

PLAN

Chandrashekhar N. Kurhe
B.E.(C) M.E.(Str.) A.M.I.E., A.L.V., A.B.M.A.
Structural Designer, Panel Architect
Corporate Valuer
Reg. No. A/3238. A.M./69340/6

OBPEED POST

F.No.25/421/2011-AWD
Government of India
Ministry of Environment & Forests
(Animal Welfare Division)

8th Floor, Jeevan Prakash Building,
25, Kasturba Gandhi Marg, New Delhi-110 001

Dated: 29th March, 2012

To

The Principal,
Nanded Pharmacy College,
Shyam Nagar,
Nanded- 431605, Maharashtra

Dr. Lina

09873621298

Subject: Registration of Establishment.

Sir,

With reference to your application on the subject mentioned above, your establishment has been registered with CPCSEA for the purpose of "Education". The Registration number is 1613/PO/a/12/CPCSEA and the registration is valid up to three months i.e., upto 28th June, 2012. The above Registration number should be quoted in all future correspondence with this office.

2. As per Rule 13 of the Breeding of and Experiments on Animals (Control and Supervision) Rules 1998, as amended, Institutional Animal Ethics Committee (IAEC) of the establishment is to be formed by CPCSEA. Accordingly, you may forward five names as per enclosed format, with their bio-data and consent within 15 days.
3. It is to inform you that, in case if you fail to submit the list of Members for the IAEC along with their bio-data and consent within the stipulated time, the above registration number with CPCSEA will stand cancel.
4. No animal should be procured for experimentation purpose, until specifically allowed by CPCSEA.
5. The Head of the Institution is only authorized to communicate with CPCSEA, until the IAEC is formed.

Yours faithfully,

Anjani Kumar
(Anjani Kumar)

Director (AW) & Member Secretary, CPCSEA
Tele:23318553

Dr. N. B. Ghaware
13/4/12

Nanded Pharmacy College
NANDED.
Inward No. _____
Date *13/4/12*



Dr. N. B. Ghaware
PRINCIPAL
Nanded Pharmacy College,
Nanded.

Print

F. No. 25/421/2011-AWD

Government of India
Ministry of Environment, Forests & Climate Change
Animal Welfare Division
O/o Committee for the Purpose of Control and Supervision of Experiments on
Animals (CPCSEA)

5th Floor, Vayu Block, Indra Paryavaran Bhawan,
Jor Bagh Road, New Delhi - 110003
09/01/2017

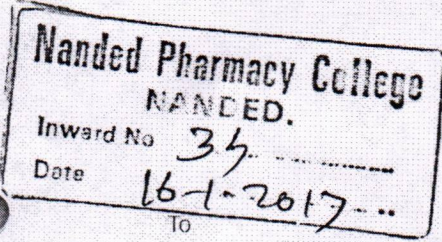

Dr. S.M. Vadvalkar, Chairman
Nanded Pharmacy College
Shri Sharda Bhavan Education Society, Shyam Nagar, Nanded -
431605, Maharashtra
Email:svadvalkar@gmail.com
Mobile:9225750393

Subject: Renewal of Registration and Reconstitution of Institutional Animals Ethics
Committee (IAEC)-regarding

Sir,

The registration of your establishment with CPCSEA has been renewed for
a period of five years from the date of issue of this letter

- The new registration number of your establishment is 1613/PO/Re/S/12/CPCSEA for Research for Education purpose on small animals. Henceforth, the new registration number may kindly be quoted in all your future correspondence with this office.
- The CPCSEA has accepted the following members recommended by the establishment:

S.No.	Name of the IAEC Members	Designation in IAEC
1	Dr C N Khobragade	Biological Scientist
2	Dr N B Ghiware	Scientist Incharge of Animal House Facility, Member Secretary
3	Dr. S M Vadvalkar	Chairperson

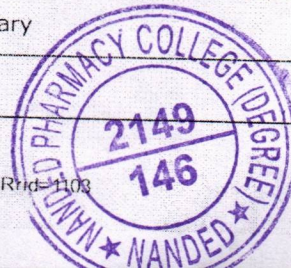

Prof.(Dr.)N.B.Ghiware
PRINCIPAL
Nanded Pharmacy College,
Nanded.

- It is stated that only above approved IAEC members shall sign, with date, on the attendance sheet of the IAEC meetings, and decisions will be taken only in meetings where quorum is complete. The quorum for holding IAEC meeting is six (6), and CPCSEA Nominees must be present in such meetings. Link Nominee can attend in case main nominee conveys his unavailability in writing to the chairman IAEC. Socially aware member's presence is compulsory in cases referred to CPCSEA and atleast in one meeting in a calendar year. Any decision taken in the meetings of IAEC without quorum shall be considered invalid.).

Yours faithfully,

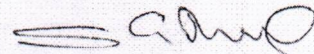

(S. Gowri Shankar)

Deputy Secretary (AW) & Member Secretary (CPCSEA)

Copy for necessary action to: Nominees of CPCSEA.

The Main Nominee is requested to ensure that the IAEC meetings are held regularly as stipulated in the SOP of CPCSEA and submit the Annual Inspection Reports of the Animal House Facility regularly on the Website of CPCSEA.

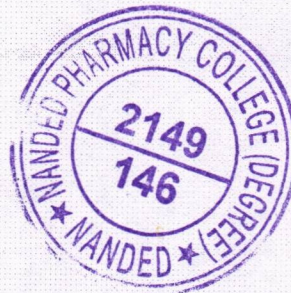

Prof. (Dr.) N. B. Ghiware
PRINCIPAL
Nanded Pharmacy College,
Nanded.



Shri Sharda Bhavan Education Society's

NANDED PHARMACY COLLEGE

Shyam Nagar, Nanded - 431 605 Maharashtra India (19.175868,77.307992)

Phone – 91 2462 254347 Tele fax No. 91 2462 254445 (O)

Visit: www.nandedpharmacycollege.org.in ; Email: ssbesnpc146@gmail.com

Affiliated to Swami Ramanand Teerth Marathwada University, Nanded, www.srtmun.ac.in

Approved by PCI & AICTE, New Delhi; College DTE Code: 2149; College SRTM University Code: 146

Ref. No. NPC / B. Pharm/
College Entrance

Date:



Principal Cabin

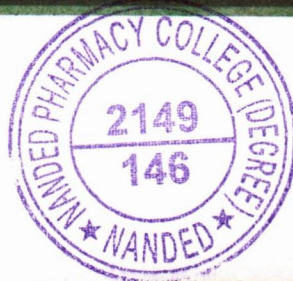

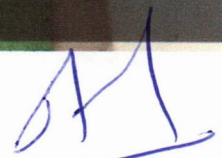
Prof. (Dr.) N.B. Ghiware
PRINCIPAL
Nanded Pharmacy College
Nanded.



Shri Sharda Bhavan Education Society's

NANDED PHARMACY COLLEGE

Shyam Nagar, Nanded - 431 605 Maharashtra India (19.175868,77.307992)

Phone – 91 2462 254347 Tele fax No. 91 2462 254445 (O)

Visit: www.nandedpharmacycollege.org.in ; Email: ssbesnpc146@gmail.com

Affiliated to Swami Ramanand Teerth Marathwada University, Nanded, www.srtmun.ac.in

Approved by PCI & AICTE, New Delhi; College DTE Code: 2149; College SRTM University Code: 146

Ref. No. NPC / B. Pharm/
Office

Date:

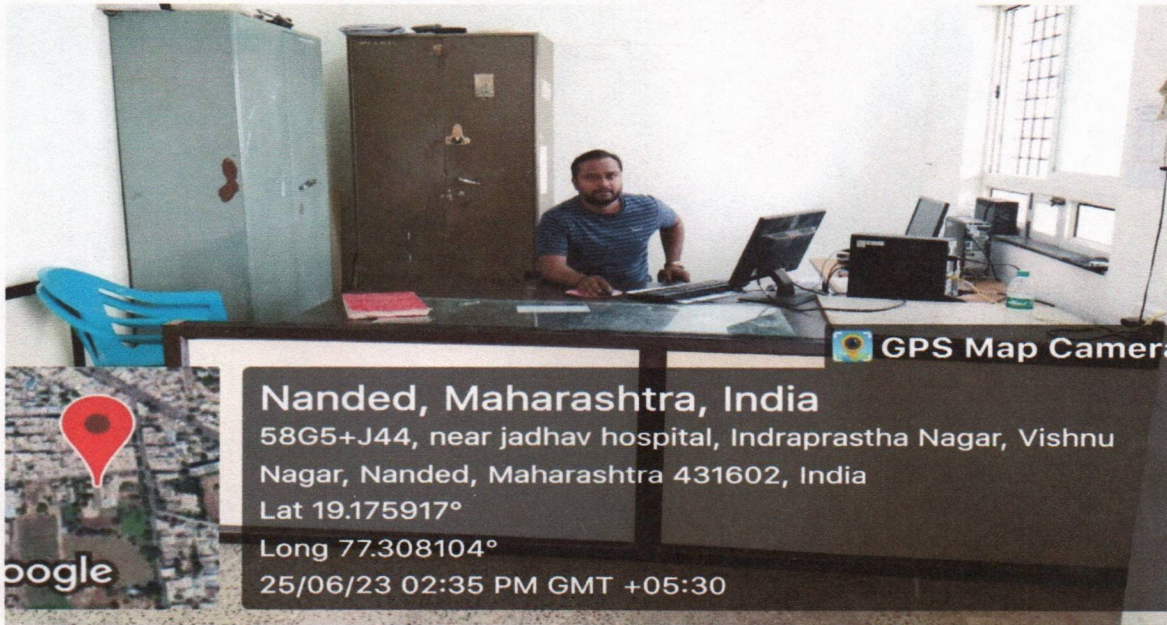

Meeting Room

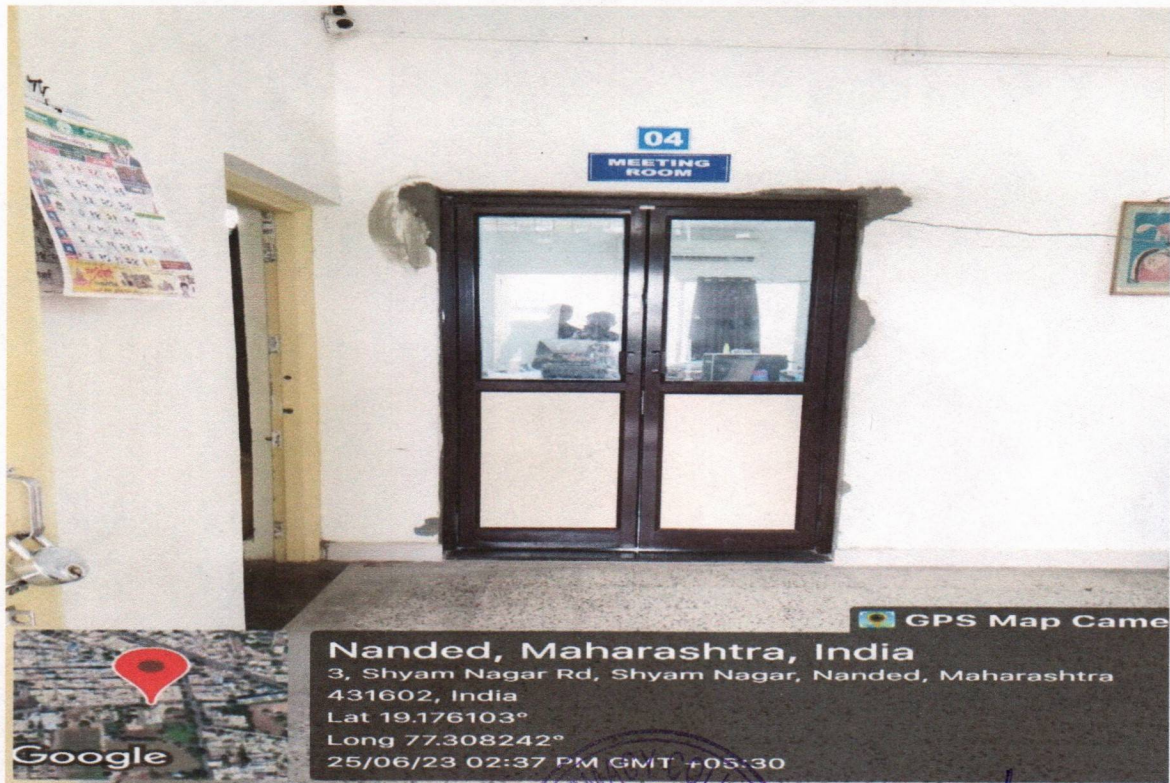

Prof.(Dr.)N.B.Ghiware
PRINCIPAL
Nanded Pharmacy College
Nanded.



Shri Sharda Bhavan Education Society's

NANDED PHARMACY COLLEGE

Shyam Nagar, Nanded - 431 605 Maharashtra India (19.175868,77.307992)

Phone – 91 2462 254347 Tele fax No. 91 2462 254445 (O)

Visit: www.nandedpharmacycollege.org.in ; Email: ssbesnpc146@gmail.com

Affiliated to Swami Ramanand Teerth Marathwada University, Nanded, www.srtmun.ac.in

Approved by PCI & AICTE, New Delhi; College DTE Code: 2149; College SRTM University Code: 146

Ref. No. NPC / B. Pharm/
Academic office /Faculty Room

Date:

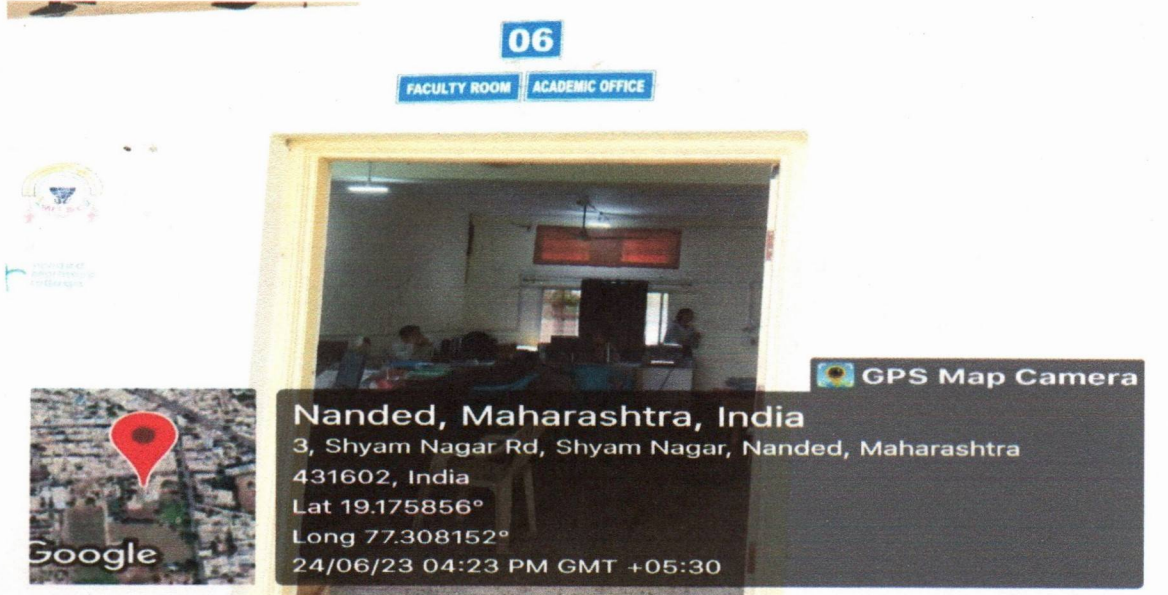

ICT enables Class room

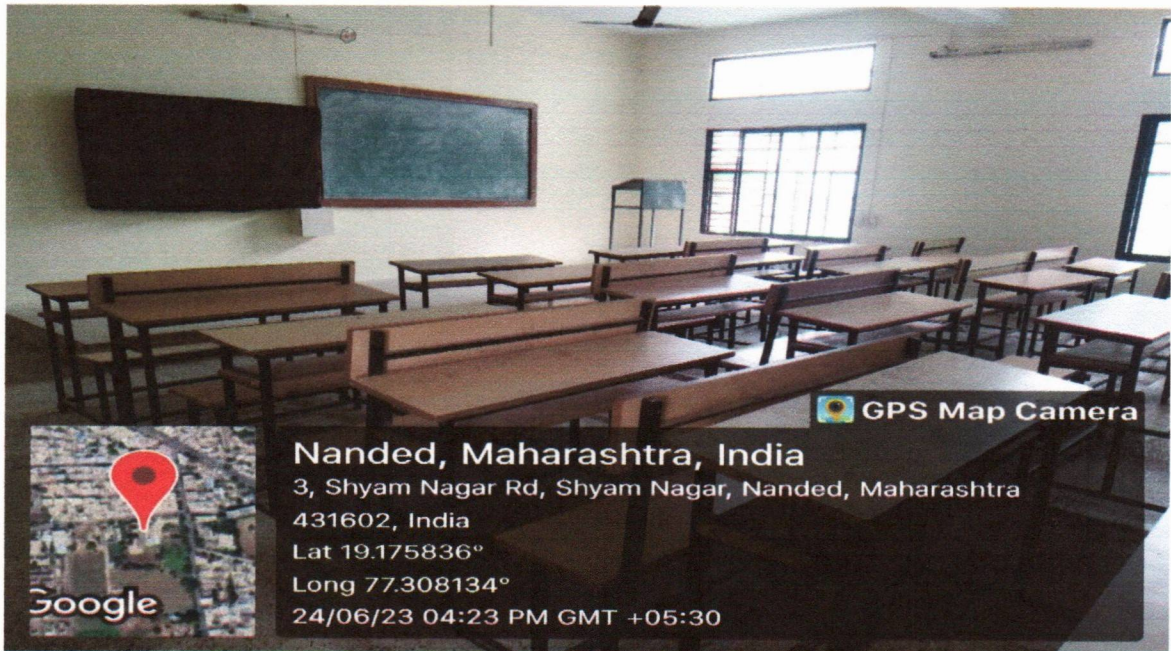

Prof.(Dr.)N.B.Ghiware
PRINCIPAL
Nanded Pharmacy College
Nanded.



Shri Sharda Bhavan Education Society's

NANDED PHARMACY COLLEGE

Shyam Nagar, Nanded - 431 605 Maharashtra India (19.175868,77.307992)

Phone – 91 2462 254347 Tele fax No. 91 2462 254445 (O)

Visit: www.nandedpharmacycollege.org.in ; Email: ssbesnpc146@gmail.com

Affiliated to Swami Ramanand Teerth Marathwada University, Nanded, www.srtmun.ac.in

Approved by PCI & AICTE, New Delhi; College DTE Code: 2149; College SRTM University Code: 146

Ref. No. NPC / B. Pharm/
Seminar Hall

Date:

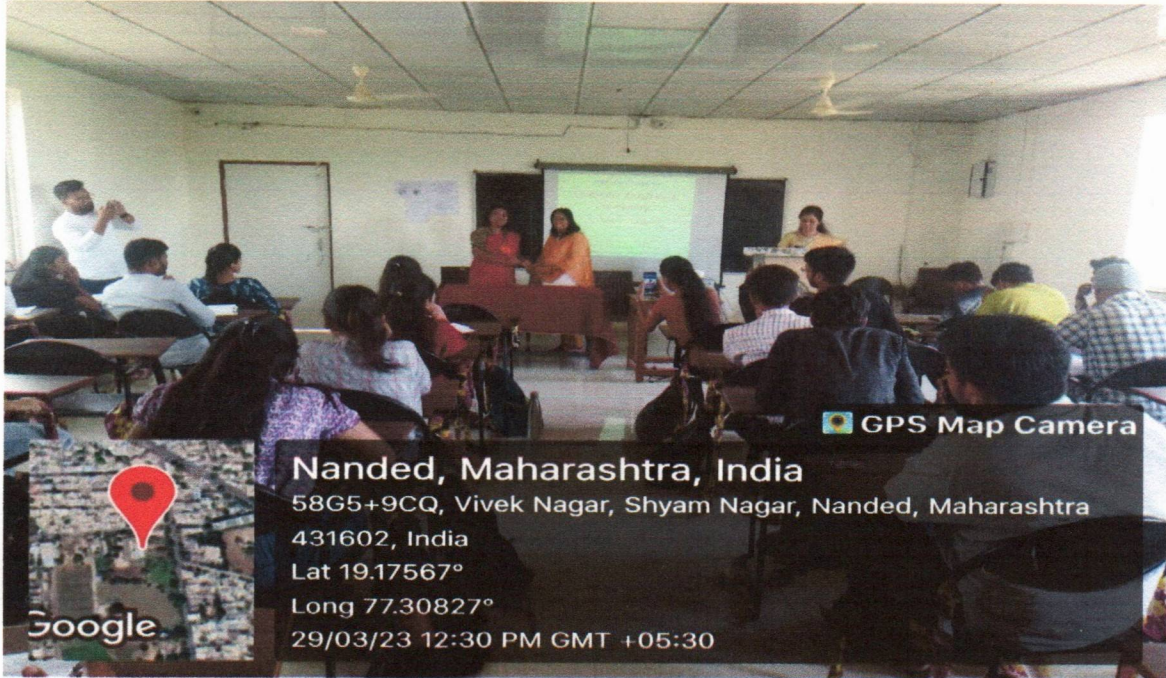

Smart Class room

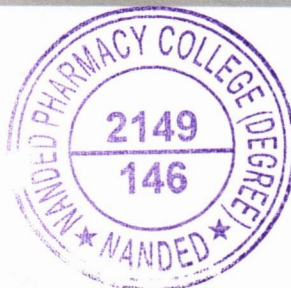
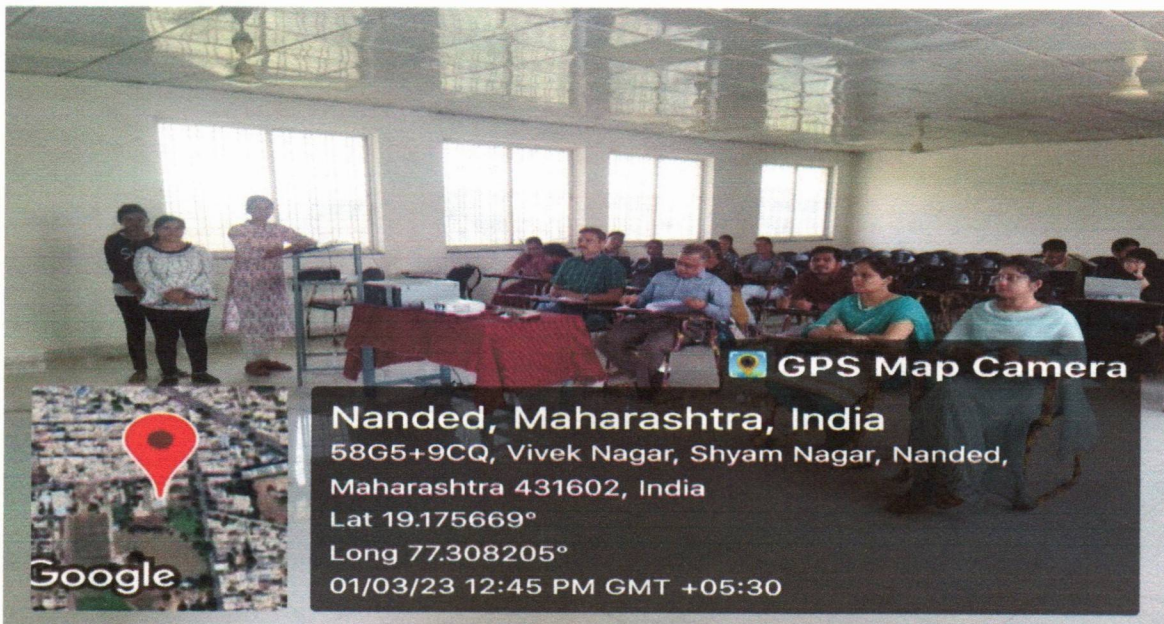

Prof. (Dr.) N.B. Ghiware
PRINCIPAL
Nanded Pharmacy College
Nanded,



Shri Sharda Bhavan Education Society's

NANDED PHARMACY COLLEGE

Shyam Nagar, Nanded - 431 605 Maharashtra India (19.175868,77.307992)

Phone – 91 2462 254347 Tele fax No. 91 2462 254445 (O)

Visit: www.nandedpharmacycollege.org.in ; Email: ssbesnpc146@gmail.com

Affiliated to Swami Ramanand Teerth Marathwada University, Nanded, www.srtmun.ac.in

Approved by PCI & AICTE, New Delhi; College DTE Code: 2149; College SRTM University Code: 146

Ref. No. NPC / B. Pharm/
Laboratory

Date:

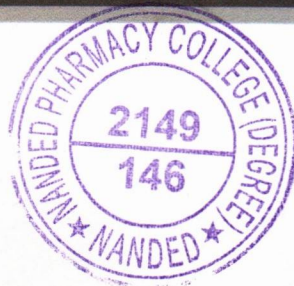
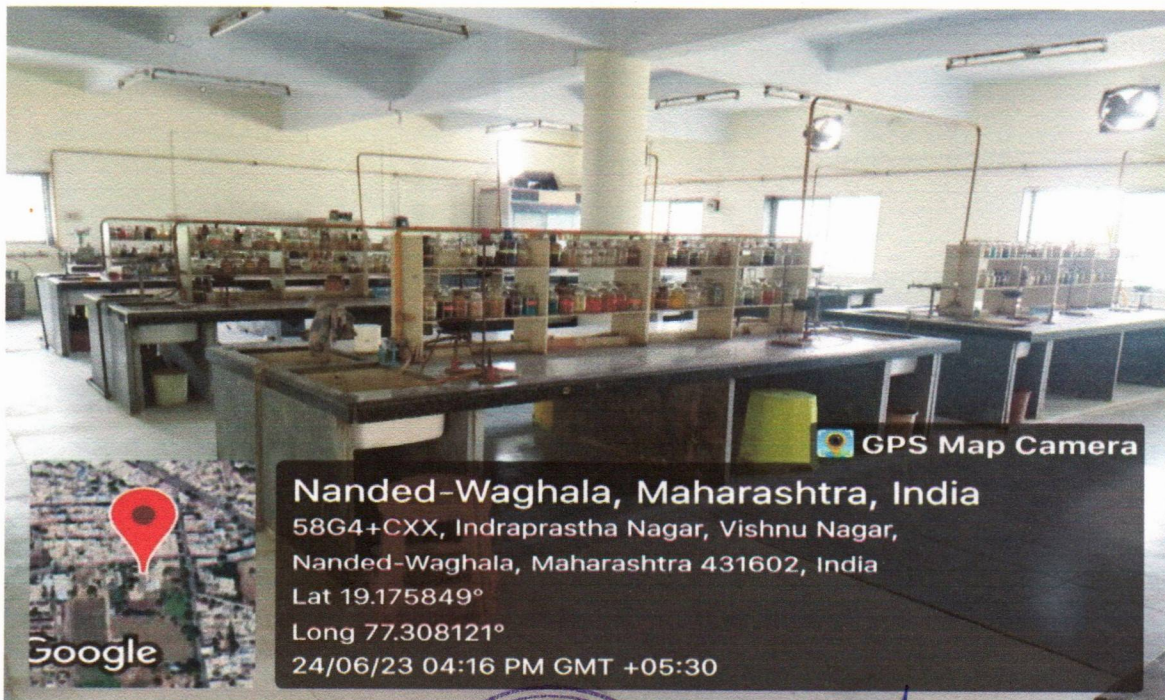
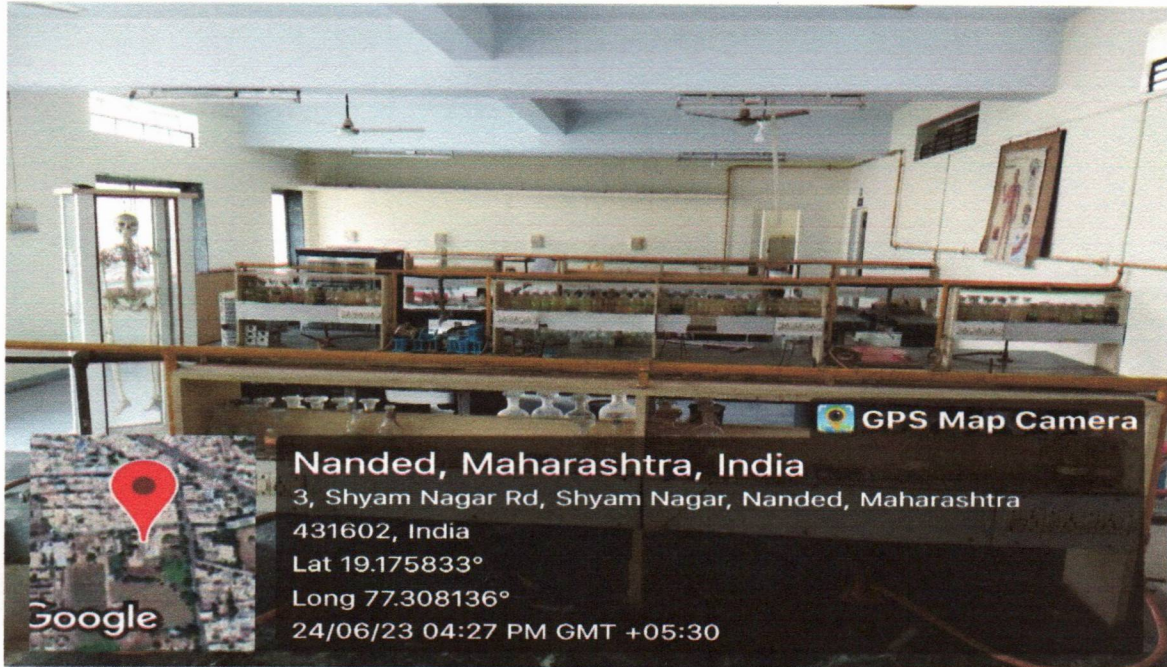

Prof.(Dr.)N.B.Ghiware
PRINCIPAL
Nanded Pharmacy College
Nanded.



Shri Sharda Bhavan Education Society's

NANDED PHARMACY COLLEGE

Shyam Nagar, Nanded - 431 605 Maharashtra India (19.175868,77.307992)

Phone – 91 2462 254347 Tele fax No. 91 2462 254445 (O)

Visit: www.nandedpharmacycollege.org.in ; Email: ssbesnpc146@gmail.com

Affiliated to Swami Ramanand Teerth Marathwada University, Nanded, www.srtmun.ac.in

Approved by PCI & AICTE, New Delhi; College DTE Code: 2149; College SRTM University Code: 146

Ref. No. NPC / B. Pharm/
Instruments Room

Date:

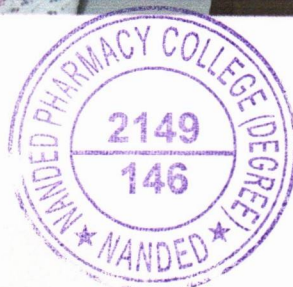
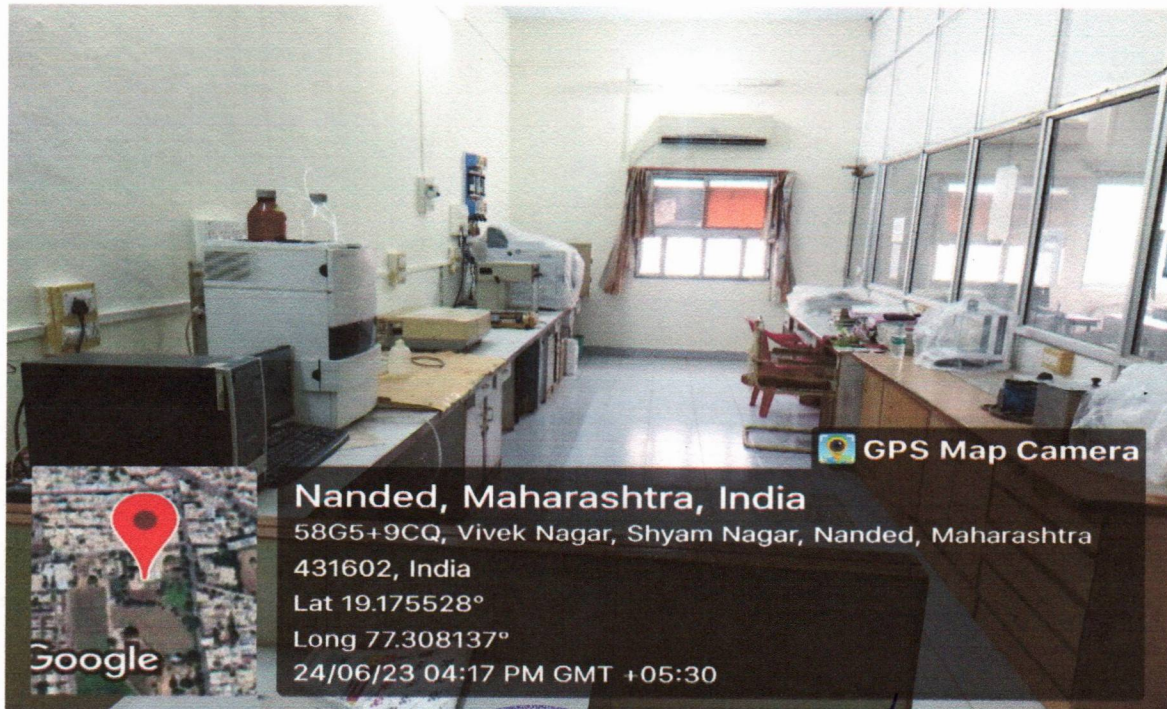
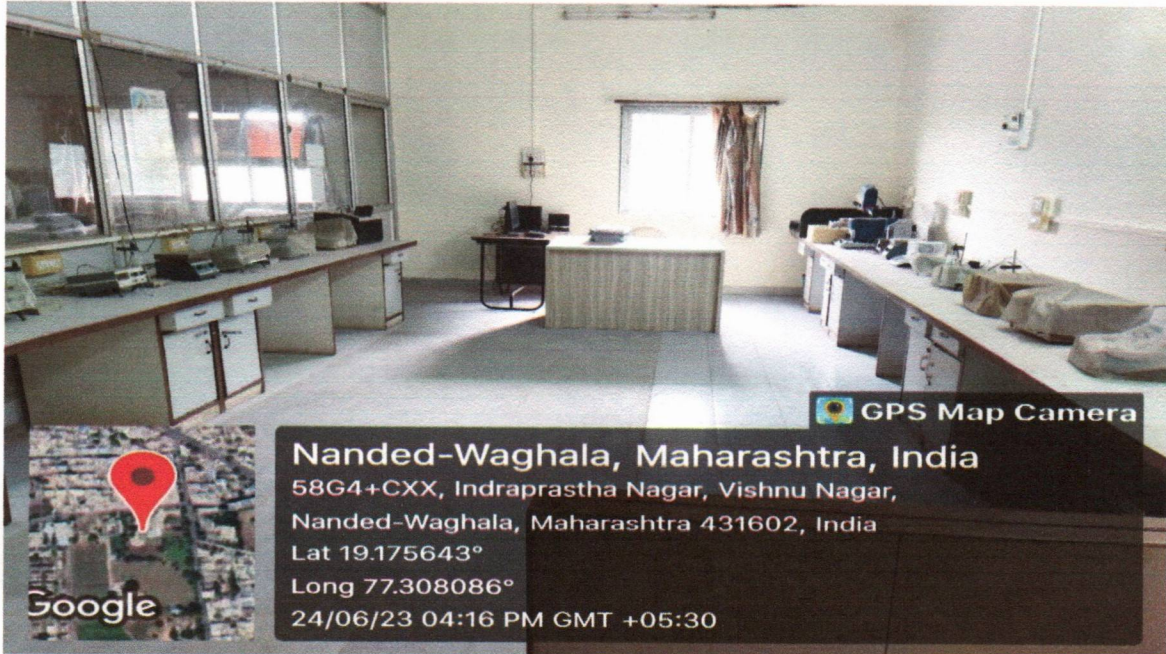

Prof.(Dr.)N.B.Ghiware
PRINCIPAL
Nanded Pharmacy College
Nanded.



Shri Sharda Bhavan Education Society's

NANDED PHARMACY COLLEGE

Shyam Nagar, Nanded - 431 605 Maharashtra India (19.175868,77.307992)

Phone – 91 2462 254347 Tele fax No. 91 2462 254445 (O)

Visit: www.nandedpharmacycollege.org.in ; Email: ssbesnpc146@gmail.com

Affiliated to Swami Ramanand Teerth Marathwada University, Nanded, www.srtmun.ac.in

Approved by PCI & AICTE, New Delhi; College DTE Code: 2149; College SRTM University Code: 146

Ref. No. NPC / B. Pharm/
Drug Museum

Date:



Library faculty reading area

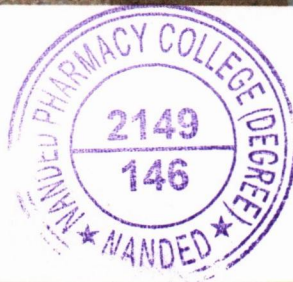
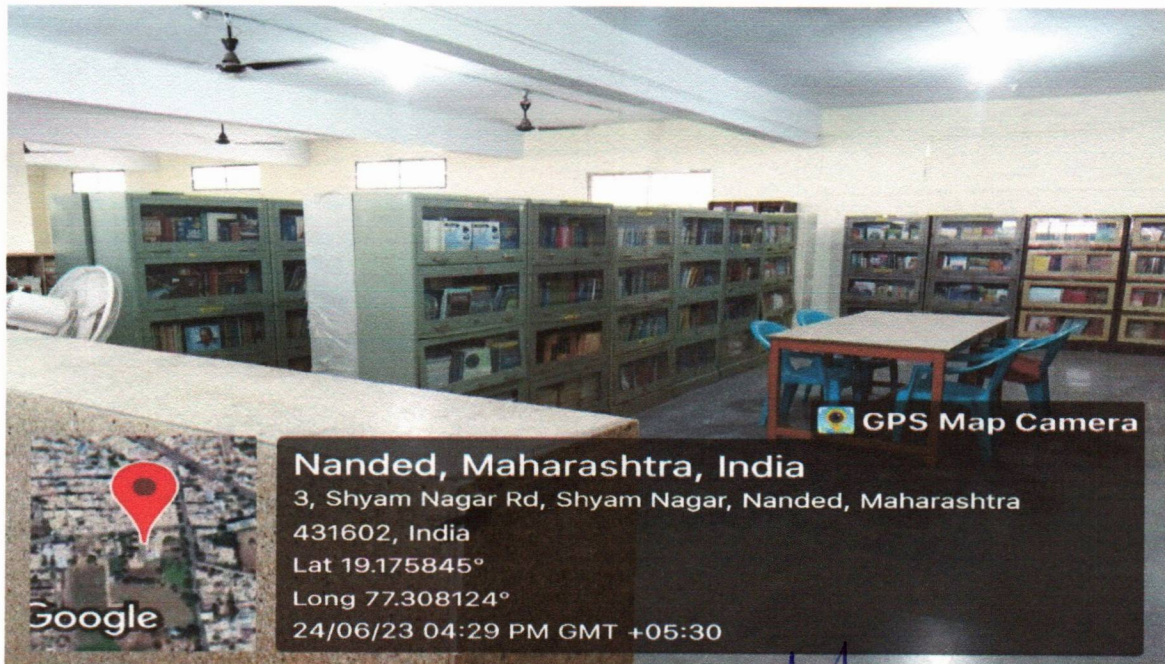

Prof. (Dr.) N.B. Ghiware
PRINCIPAL
Nanded Pharmacy College
Nanded.



Shri Sharda Bhavan Education Society's

NANDED PHARMACY COLLEGE

Shyam Nagar, Nanded - 431 605 Maharashtra India (19.175868,77.307992)

Phone – 91 2462 254347 Tele fax No. 91 2462 254445 (O)

Visit: www.nandedpharmacycollege.org.in ; Email: ssbesnpc146@gmail.com

Affiliated to Swami Ramanand Teerth Marathwada University, Nanded, www.srtmun.ac.in

Approved by PCI & AICTE, New Delhi; College DTE Code: 2149; College SRTM University Code: 146

Ref. No. NPC / B. Pharm/
Library

Date:

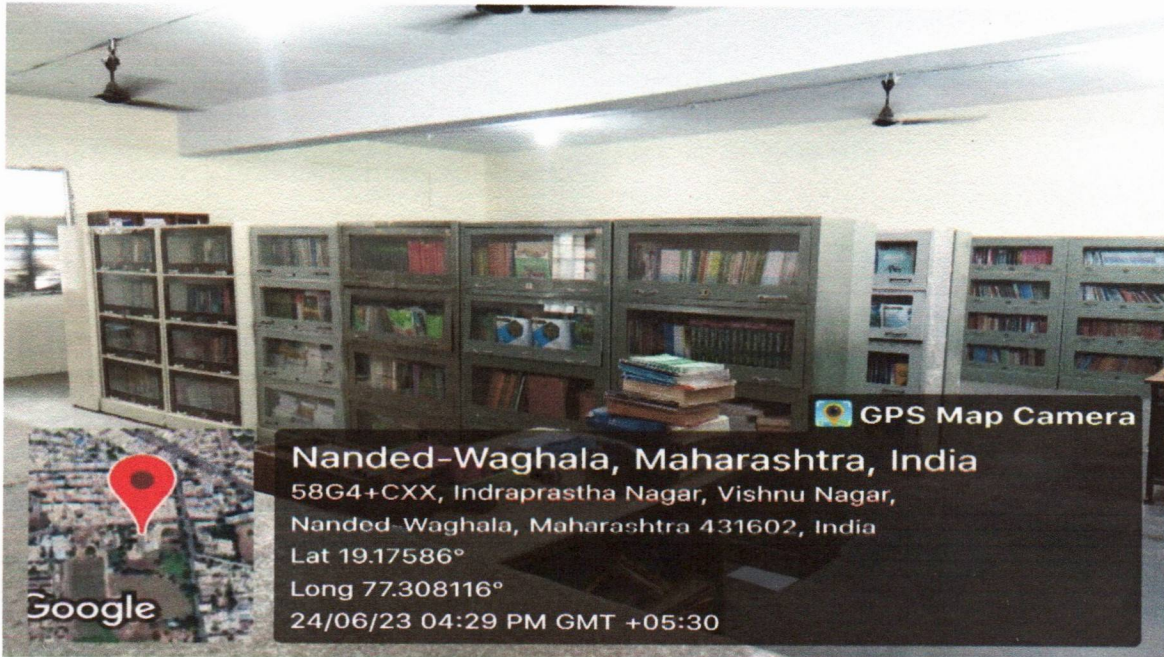

Library Student reading area

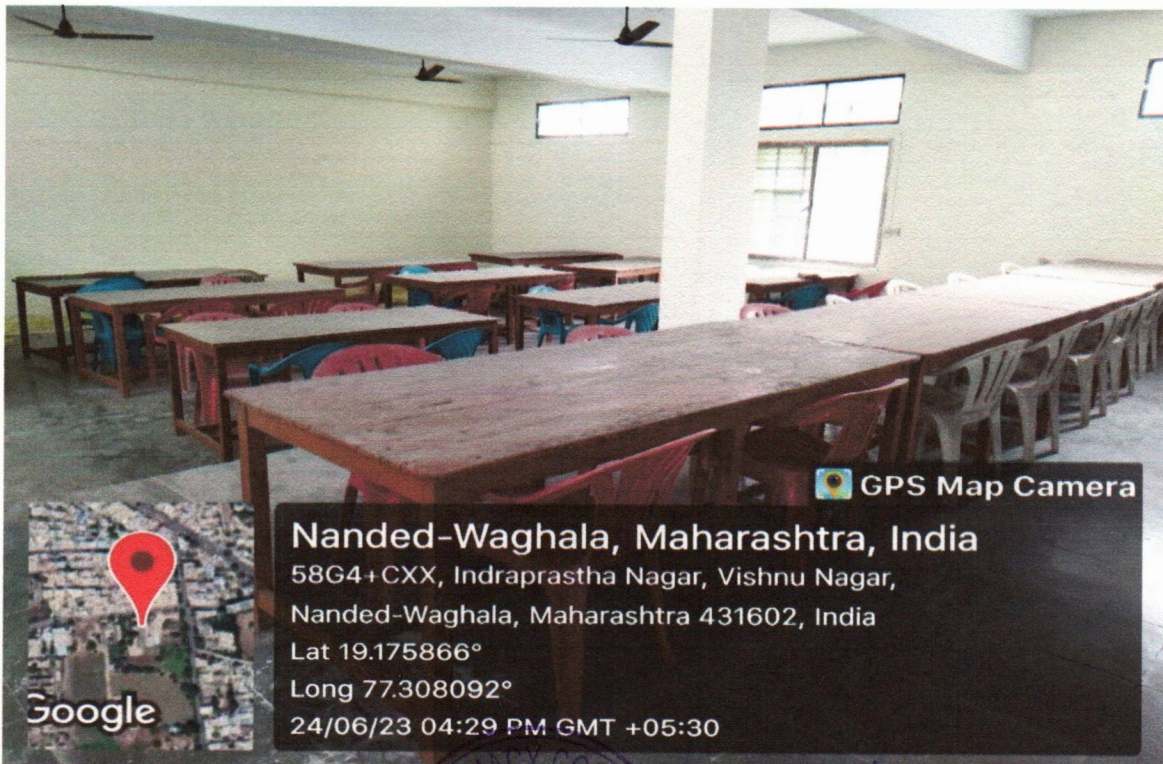

Prof. (Dr.) N.B. Ghiware
PRINCIPAL
Nanded Pharmacy College
Nanded.



Shri Sharda Bhavan Education Society's

NANDED PHARMACY COLLEGE

Shyam Nagar, Nanded - 431 605 Maharashtra India (19.175868,77.307992)

Phone – 91 2462 254347 Tele fax No. 91 2462 254445 (O)

Visit: www.nandedpharmacycollege.org.in ; Email: ssbesnpc146@gmail.com

Affiliated to Swami Ramanand Teerth Marathwada University, Nanded, www.srtmun.ac.in

Approved by PCI & AICTE, New Delhi; College DTE Code: 2149; College SRTM University Code: 146

Ref. No. NPC / B. Pharm/

Date:

Computer Lab /Language Lab

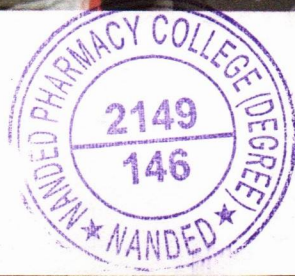
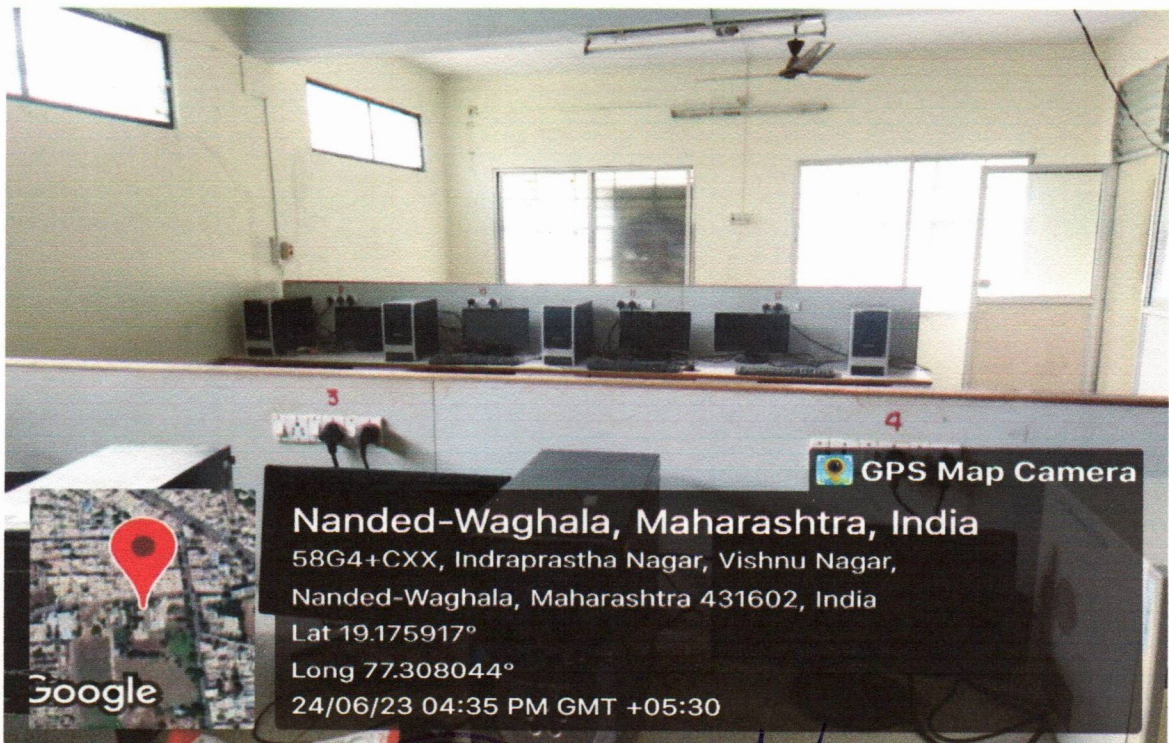
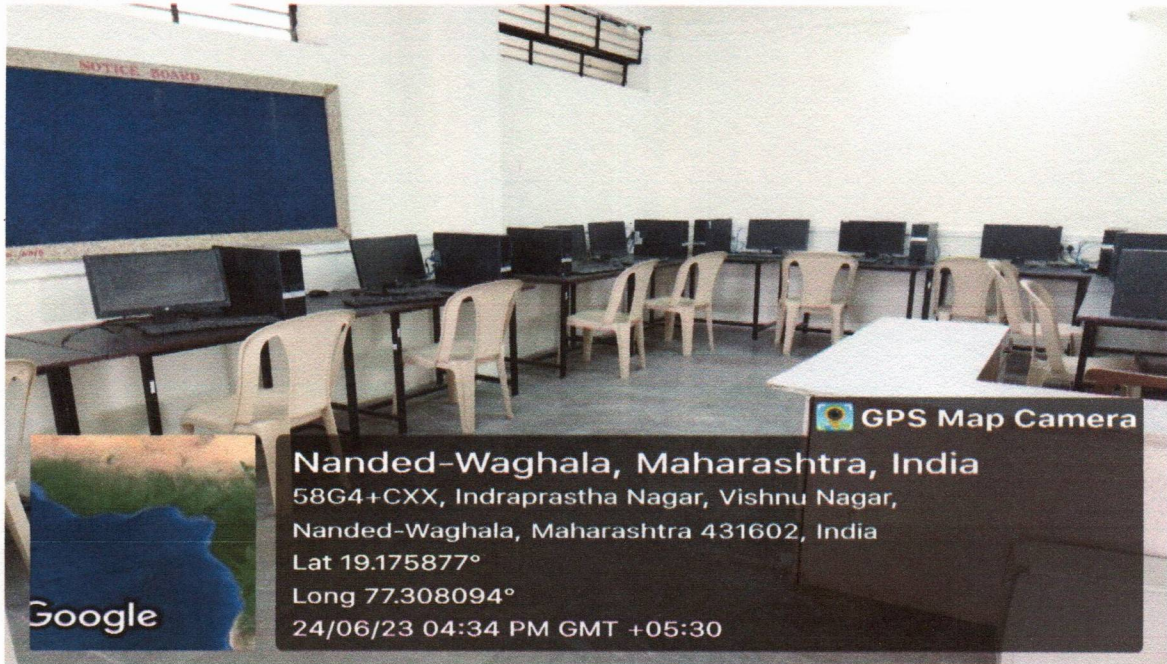

Prof.(Dr.)N.B.Ghiware
PRINCIPAL
Nanded Pharmacy College
Nanded.



Shri Sharda Bhavan Education Society's

NANDED PHARMACY COLLEGE

Shyam Nagar, Nanded - 431 605 Maharashtra India (19.175868,77.307992)

Phone – 91 2462 254347 Tele fax No. 91 2462 254445 (O)

Visit: www.nandedpharmacycollege.org.in ; Email: ssbesnpc146@gmail.com

Affiliated to Swami Ramanand Teerth Marathwada University, Nanded, www.srtmun.ac.in

Approved by PCI & AICTE, New Delhi; College DTE Code: 2149; College SRTM University Code: 146

Ref. No. NPC / B. Pharm/
Machine Room

Date:



Animal House

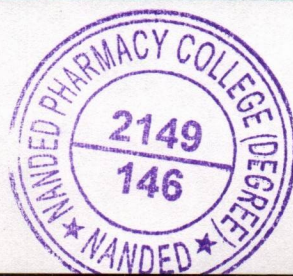
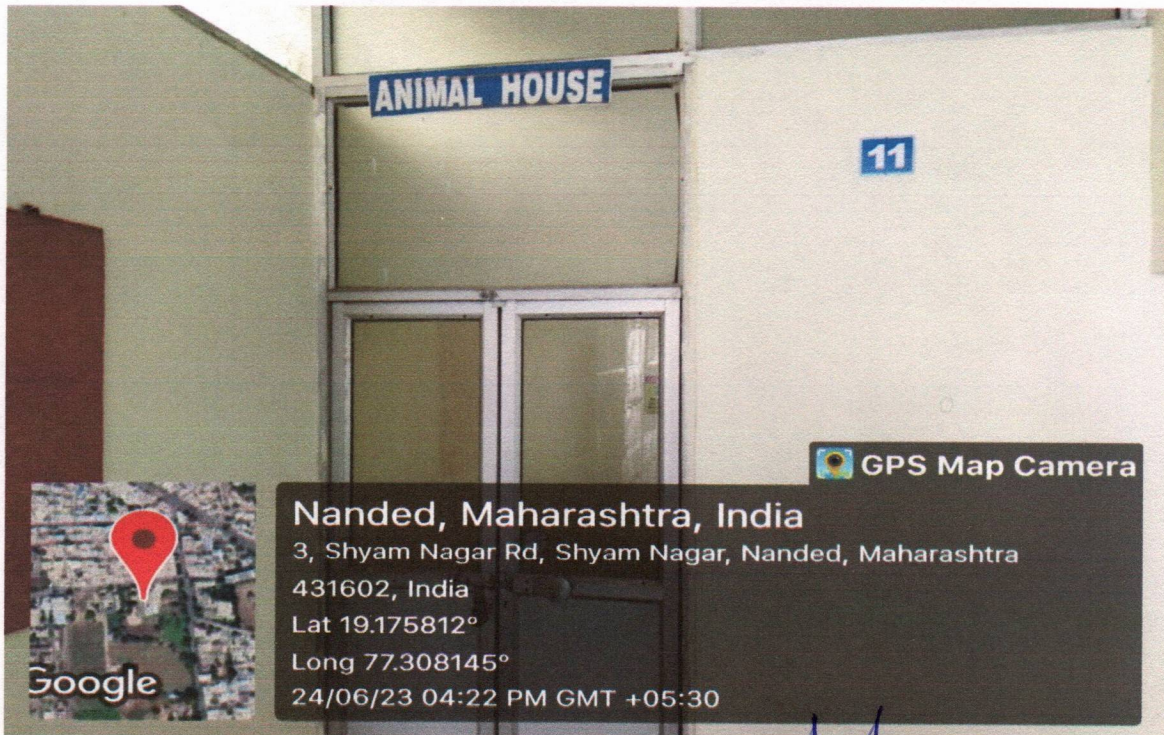

Prof.(Dr.)N.B.Ghiware
PRINCIPAL
Nanded Pharmacy College
Nanded.



Shri Sharda Bhavan Education Society's

NANDED PHARMACY COLLEGE

Shyam Nagar, Nanded - 431 605 Maharashtra India (19.175868,77.307992)

Phone – 91 2462 254347 Tele fax No. 91 2462 254445 (O)

Visit: www.nandedpharmacycollege.org.in ; Email: ssbesnpc146@gmail.com

Affiliated to Swami Ramanand Teerth Marathwada University, Nanded, www.srtmun.ac.in

Approved by PCI & AICTE, New Delhi; College DTE Code: 2149; College SRTM University Code: 146

Ref. No. NPC / B. Pharm/
Open Auditorium

Date:



Sports Ground

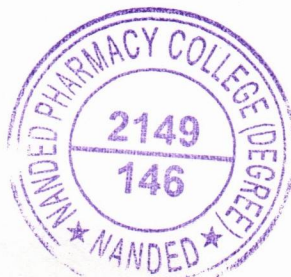
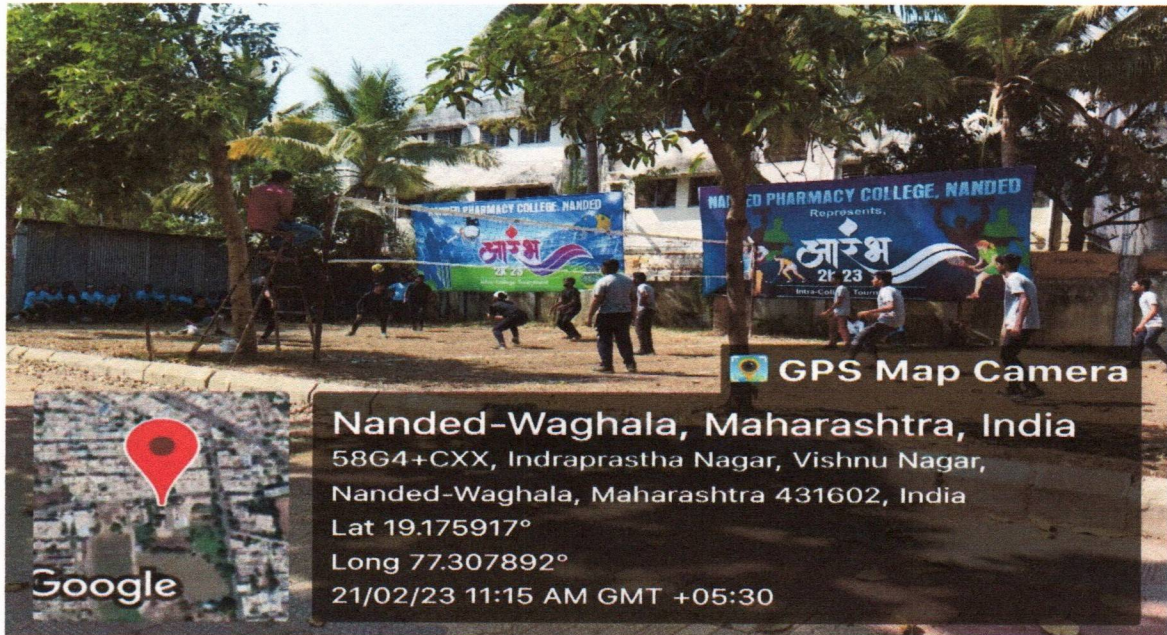

Prof. (Dr.) N.B. Ghiware
PRINCIPAL
Nanded Pharmacy College
Nanded.



Shri Sharda Bhavan Education Society's

NANDED PHARMACY COLLEGE

Shyam Nagar, Nanded - 431 605 Maharashtra India (19.175868,77.307992)

Phone – 91 2462 254347 Tele fax No. 91 2462 254445 (O)

Visit: www.nandedpharmacycollege.org.in ; Email: ssbesnpc146@gmail.com

Affiliated to Swami Ramanand Teerth Marathwada University, Nanded, www.srtmun.ac.in

Approved by PCI & AICTE, New Delhi; College DTE Code: 2149; College SRTM University Code: 146

Ref. No. NPC / B. Pharm/
Drinking Water Facility

Date:

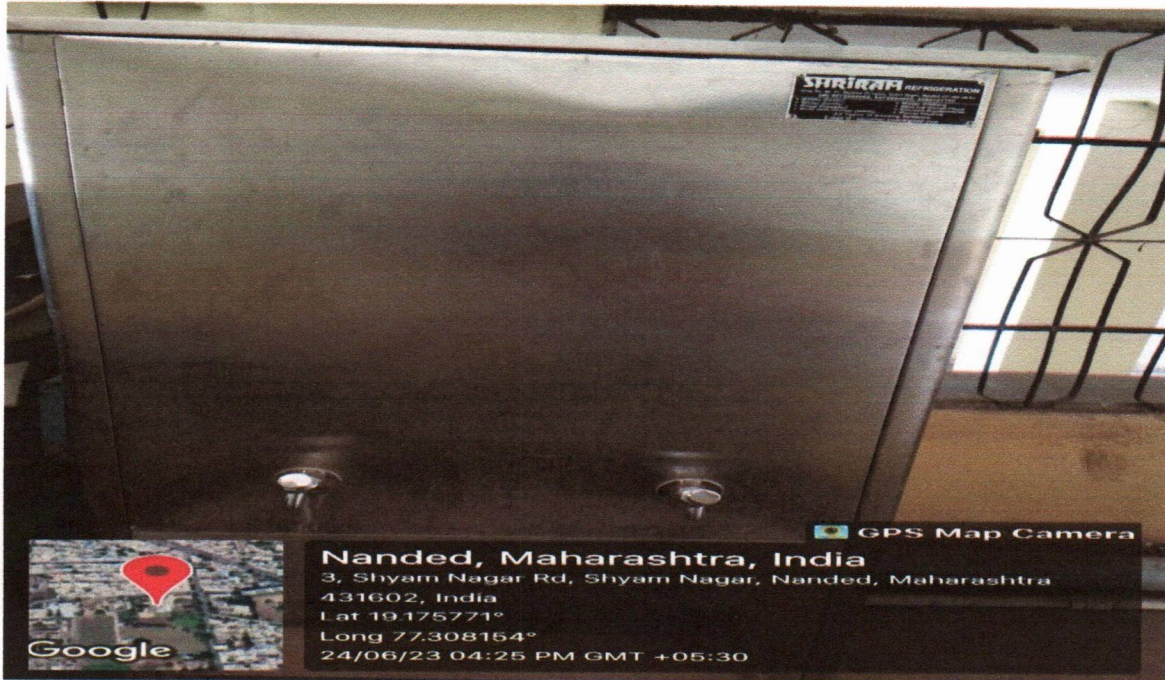

Sanitary Napkin Vending Machine

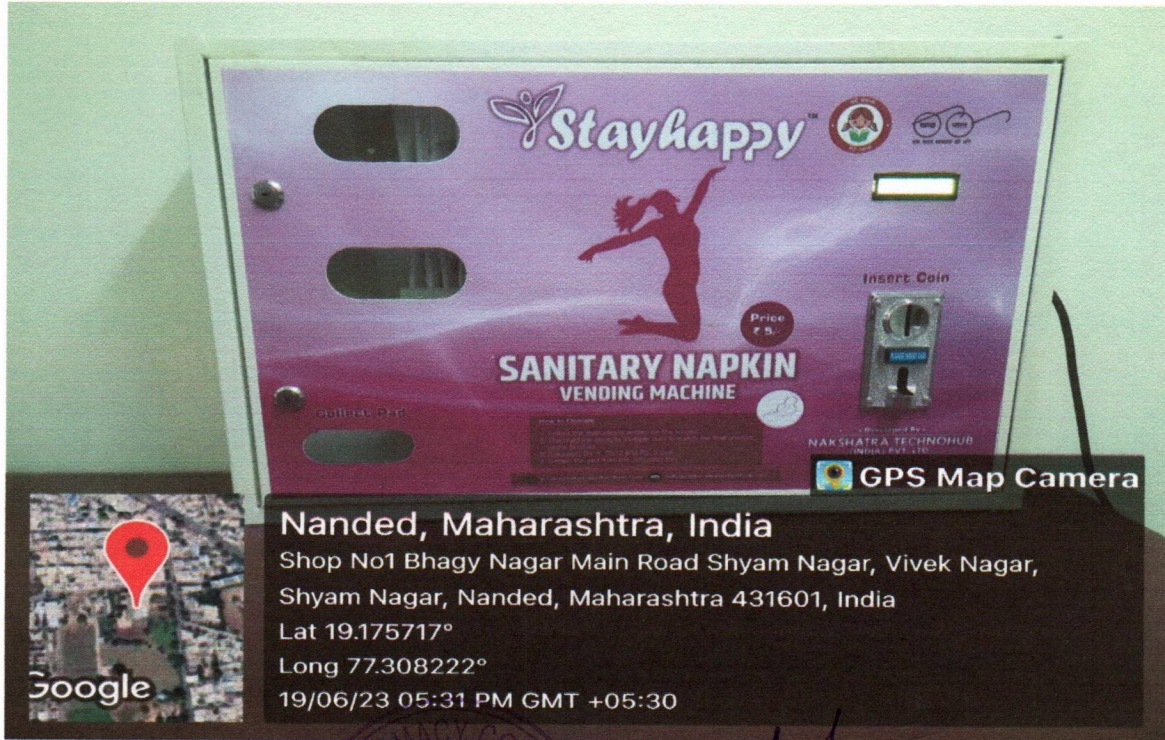

[Signature]
Prof.(Dr.)N.B.Ghiware
PRINCIPAL
Nanded Pharmacy College
Nanded.



Shri Sharda Bhavan Education Society's

NANDED PHARMACY COLLEGE

Shyam Nagar, Nanded - 431 605 Maharashtra India (19.175868,77.307992)

Phone – 91 2462 254347 Tele fax No. 91 2462 254445 (O)

Visit: www.nandedpharmacycollege.org.in ; Email: ssbesnpc146@gmail.com

Affiliated to Swami Ramanand Teerth Marathwada University, Nanded, www.srtmun.ac.in

Approved by PCI & AICTE, New Delhi; College DTE Code: 2149; College SRTM University Code: 146

Ref. No. NPC / B. Pharm/

Date:

Sanitary Napkin Disposal Machine

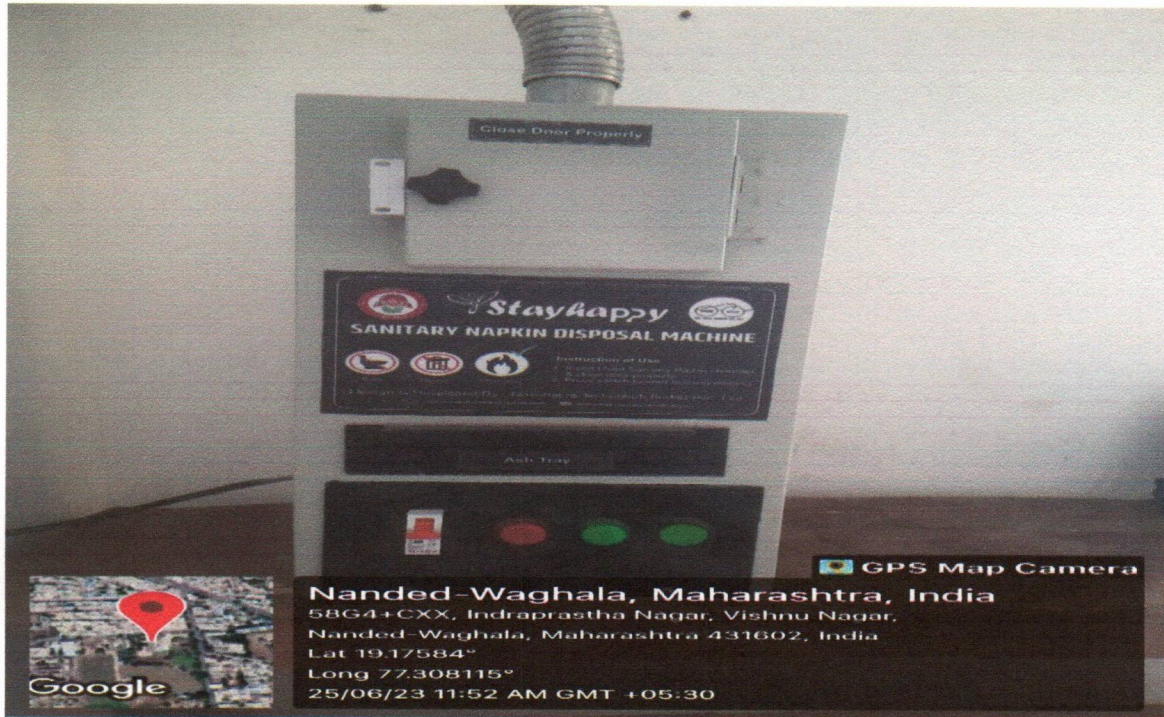

Power backup

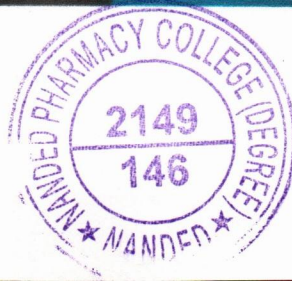
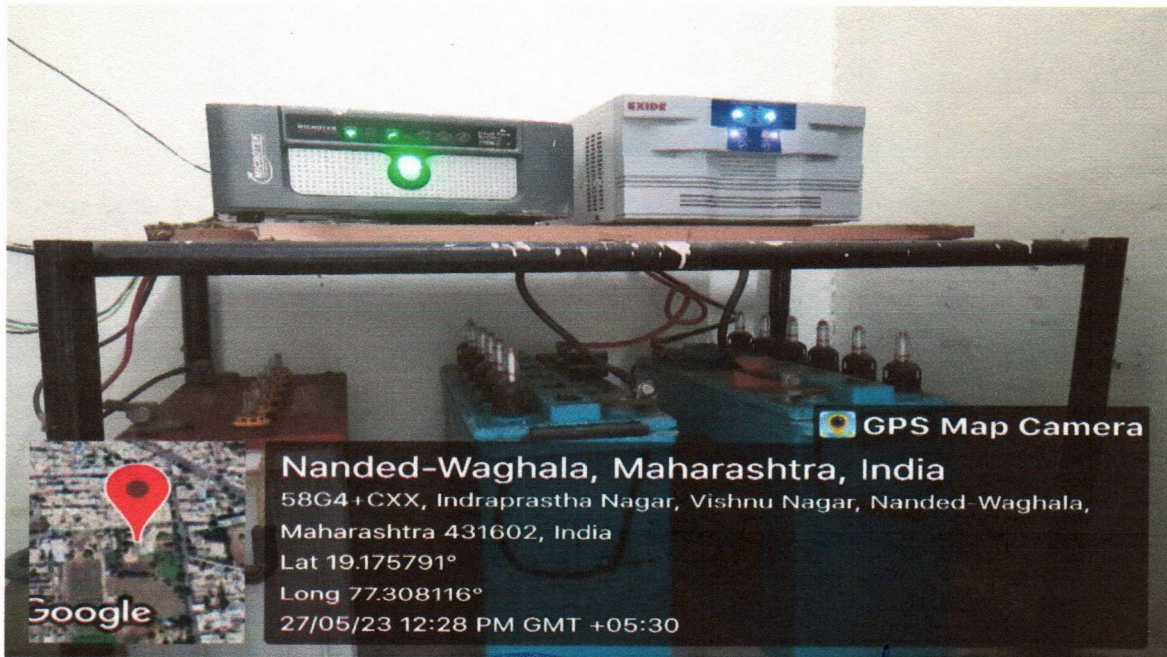

Prof.(Dr.)N.B.Ghiware
PRINCIPAL
Nanded Pharmacy College
Nanded.



Shri Sharda Bhavan Education Society's

NANDED PHARMACY COLLEGE

Shyam Nagar, Nanded - 431 605 Maharashtra India (19.175868,77.307992)

Phone – 91 2462 254347 Tele fax No. 91 2462 254445 (O)

Visit: www.nandedpharmacycollege.org.in ; Email: ssbesnpc146@gmail.com

Affiliated to Swami Ramanand Teerth Marathwada University, Nanded, www.srtmun.ac.in

Approved by PCI & AICTE, New Delhi; College DTE Code: 2149; College SRTM University Code: 146

Ref. No. NPC / B. Pharm/

Date:

Inverter with power Backup



GPS Map Camera



Google

Nanded, Maharashtra, India

58G5+J44, near jadhav hospital, Indraprastha Nagar, Vishnu

Nagar, Nanded, Maharashtra 431602, India

Lat 19.175903°

Long 77.308106°

27/05/23 12:23 PM GMT +05:30

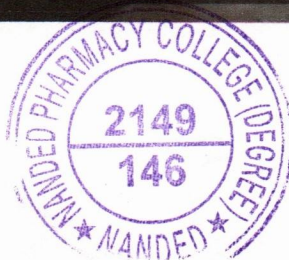

Prof.(Dr.)N.B.Ghiware
PRINCIPAL
Nanded Pharmacy College
Nanded.



Shri Sharda Bhavan Education Society's

NANDED PHARMACY COLLEGE

Shyam Nagar, Nanded - 431 605 Maharashtra India (19.175868,77.307992)

Phone – 91 2462 254347 Tele fax No. 91 2462 254445 (O)

Visit: www.nandedpharmacycollege.org.in ; Email: ssbesnpc146@gmail.com

Affiliated to Swami Ramanand Teerth Marathwada University, Nanded, www.srtmun.ac.in

Approved by PCI & AICTE, New Delhi; College DTE Code: 2149; College SRTM University Code: 146

Ref. No. NPC / B. Pharm/
Yoga Centre

Date:



Indoor Game.

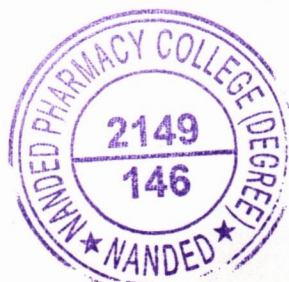

Prof.(Dr.)N.B.Ghiware
PRINCIPAL
Nanded Pharmacy College
Nanded.